

# "D04ET" SERIES COSTECH FANS

Description: **d.c. axial fan 40x40x10 mm**

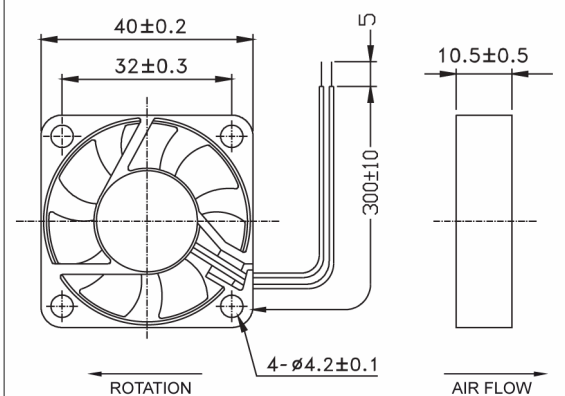

**Casing material:**

Black fibreglass reinforced plastic (PBT) UL 94V-0

**Impeller material:**

Black fibreglass reinforced plastic (PBT) UL 94V-0

**Protection degree:**

IP20, according to EN 60529 standard

**Fixing system:**

4 holes ∅4.2 mm

**Motor protection:**

impedance

**Storage temperature:**

from -40°C to +70°C

**Rated temperature range:**

from -10°C to +70°C

**Lifetime L10 at 40°C:**

Sleeve 22,000 h ; Ball 70,000 h

**Lifetime L10 at 25°C:**

Hypro 50,000 h

**Electrical connection:**

2 leads 26AWG UL 1007, 300 mm long

**Weight:**

17 g

**Approvals:**

CE; UL E223195

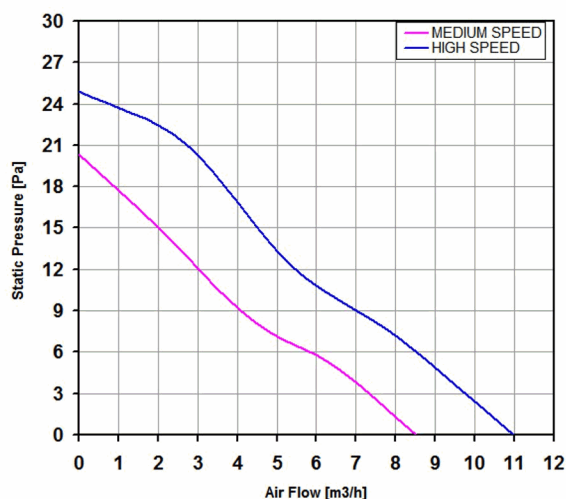

Model	Bearing	Voltage	Rated Current	Rated Power	Max Air Flow	Static Pressure	Noise	RPM	Approvals
		(V)	(A)	(W)	(m3/h)	(Pa)	[db(A)]	(rpm)	
D04E01HWBT00	Ball	5 V d.c.	0.190	0.95	11	25	26.0	6,000	CE; cURus
D04E01HWHT00	Hypro	5 V d.c.	0.190	0.95	11	25	31.0	6,000	CE; cURus
D04E01MWBT00	Ball	5 V d.c.	0.110	0.55	8.5	19	22.0	4,800	CE; cURus
D04E01MWHT00	Hypro	5 V d.c.	0.110	0.55	8.5	19	22.0	4,800	CE; cURus
D04E04HWBT00	Ball	12 V d.c.	0.100	1.2	10	25	30.5	6,000	CE; cURus
D04E04HWHT00	Hypro	12 V d.c.	0.100	1.2	11	25	26.0	6,200	CE; cURus
D04E04MWBT00	Ball	12 V d.c.	0.080	0.96	8.5	19	22.0	4,800	CE; cURus
D04E04MWST00	Sleeve	12 V d.c.	0.080	0.96	8.5	19	22.0	4,800	CE; cURus
D04E05HWBT00	Ball	24 V d.c.	0.090	2.16	10	25	30.5	6,000	CE; cURus
D04E05HWHT00	Hypro	24 V d.c.	0.090	2.16	11	25	30.5	6,000	CE; cURus
D04E05MWBT00	Ball	24 V d.c.	0.080	1.9	8.5	19	22.0	4,800	CE; cURus
D04E05MWST00	Sleeve	24 V d.c.	0.080	1.9	8.5	19	22.0	4,800	CE; cURus