

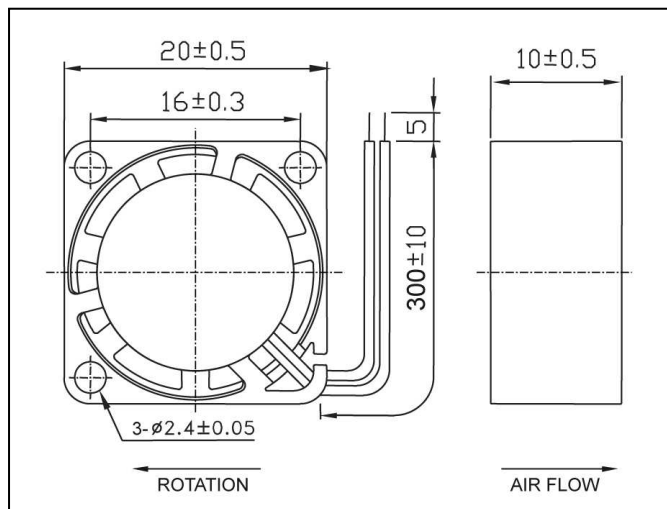

**DRAWING**



**FEATURES**

- Glass fibre reinforced plastic (PBT) fan casing and impeller.
- Brushless dc motor. I.C. protected against running overload.
- Electrical connection via 2 leads UL1007 AWG24, 300mm long.
- Rated temperature range:  
Ball bearing from -20°C to +70°C  
Sleeve bearing from -10°C to +60°C
- Service life L10:  
Ball bearing 70,000 hours at 40°C  
40,000 hours at t max  
Sleeve bearing 50,000 hours at 40°C  
35,000 hours at t max
- Weight 5g.

**AIR FLOW CURVES**

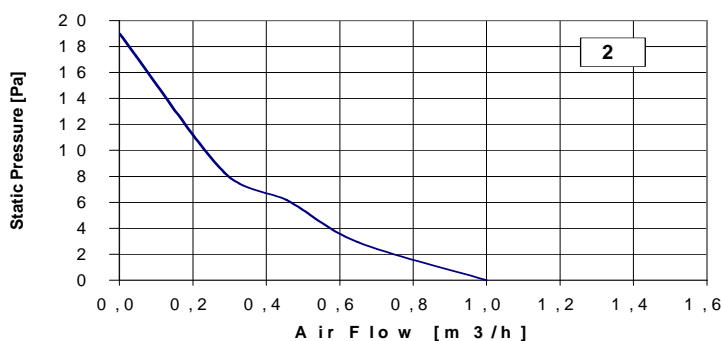
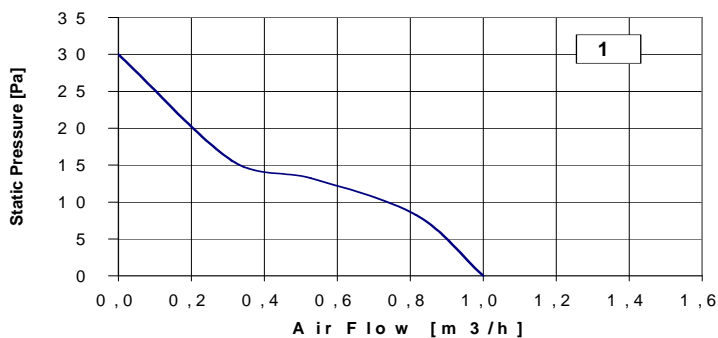

Please refer to our terms of sales including our warranty and limited liabilities clauses.

Model	Diagram	Bearing #		Rated Voltage [V]	Input Power [W]	Speed [rpm]	Air Flow [m³/h]	Static Pressure [Pa]	Noise [dB(A)]	Approvals		
		S	B							UL	CUL	TUV
D20E01MW#A00	1	★	★	5	0.4	11500	1.0	30	20.1			
D20E01LW#A00	2	★	★	5	0.3	9000	1.0	19	20.0	H,B		
D20E04MW#A00	1	★	★	12	0.7	11500	1.0	30	20.1			
D20E04LW#A00	2	★	★	12	0.7	9000	1.0	19	20.0	H	H	

“#” : S= Sleeve, B= Ball