

Data sheet

Commercial Art.No.: 70.358.1635.0

Hood BAS GOT GD 16 M32 A0

revos BASIC size 16 hood with cable gland M32, lateral cable entry, with double locking levers

1011011010001010010101101
0100110110010110100101010
101001101100111001010010
10101001010101010101010
1101010011011001011010010
10101010010101101010010
10101010010101101010011

**DIGITALIZATION
IN PROGRESS**

Commercial Art.No.	70.358.1635.0
EAN	4015573650985
Order Unit	1

Technical data

General

Housing material	Aluminium
Colour	Grey
Surface	With powder coating
Degree of protection (IP)	IP54
UV resistant	Yes
Inflammability class of insulation material acc. with UL94	Other
Operating temperature range min.	-40 °C
Operating temperature range max.	120 °C

Model

DIN-size	16
Model	male
Locking mechanism	Double locking levers
Cable entry	Sideways
Type of cable	Gland nut
With cable screw gland	Yes
Thread size M	32
Thread size PG	
Hinged lid	No
EMC-version	No
Length	94 mm
Width	56 mm
Height	60 mm

Classification

ECLASS 8.1	27440202
ETIM 7.0	EC000437
ETIM 6.0	EC000437
ETIM 5.0	EC000437
ETIM 4.0	EC000437

ETIM 3.0	EC000437
----------	----------

Fits with

Commercial Art.No.:	Article-type description:	Description:
70.325.1628.0	Bottom BAS GUT GE 16 A	revos BASIC size 16 open-bottom base, with cover, double locking lever
70.340.1635.0	Bottom BAS GUT GF 16 M25 A0	revos BASIC size 16 closed-bottom base with 2 cable glands M25, with cover, double locking lever
70.340.1635.1	Bottom BAS GUT GF 16 M25 A1	revos BASIC size 16 closed-bottom base with 2 threaded collars M25, with cover, double locking lever
70.341.1635.0	Bottom BAS GUT GG 16 M25 A0	revos BASIC size 16 closed-bottom base with cable gland M25, left, with cover, double locking lever
70.341.1635.1	Bottom BAS GUT GG 16 M25 A1	revos BASIC size 16 closed-bottom base with threaded collar M25, left, with cover, double locking lever
70.342.1635.0	Bottom BAS GUT GH 16 M25 A0	revos BASIC size 16 closed-bottom base with cable gland M25, right, with cover, double locking lever
70.342.1635.1	Bottom BAS GUT GH 16 M25 A1	revos BASIC size 16 closed-bottom base with threaded collar M25, right, with cover, double locking lever
70.343.1635.0	Bottom BAS GUT GI 16 M25 A0	revos BASIC size 16 closed-bottom base with cable gland M25, bottom, with cover, double locking lever
70.343.1635.1	Bottom BAS GUT GI 16 M25 A1	revos BASIC size 16 closed-bottom base with threaded collar M25, bottom, with cover, double locking lever
73.340.4035.0	Bottom BAS GUT GB 16H M40 A1	revos BASIC size 16H closed-bottom base with 2 cable glands M25, with cover, high design, double locking lever
73.340.4035.1	Bottom BAS GUT GF 16HM25 50 A1	revos BASIC size 16H closed-bottom base with 2 threaded collars M25, with cover, high design, double locking lever
73.341.4035.0	Bottom BAS GUT GC 16H M40 A1	revos BASIC size 16H closed-bottom base with cable gland M25, left, with cover, high design, double locking lever
73.341.4035.1	Bottom BAS GUT GG 16HM25 50 A1	revos BASIC size 16H closed-bottom base with threaded collar M253, left, with cover, high design, double locking lever
73.342.4035.0	Bottom BAS GUT GH 16HM25 50 A0	revos BASIC size 16H closed-bottom base with cable gland M25, right, with cover, high design, double locking lever
73.342.4035.1	Bottom BAS GUT GH 16HM25 50 A1	revos BASIC size 16H closed-bottom base with threaded collar M25, right, with cover, high design, double locking lever
73.343.4035.0	Bottom BAS GUT GI 16HM25 50 A0	revos BASIC size 16H closed-bottom base with cable gland M25, bottom, with cover, high design, double locking lever
73.343.4035.1	Bottom BAS GUT GI 16HM25 50 A1	revos BASIC size 16H closed-bottom base with threaded collar M25, bottom, with cover, high design, double locking lever
73.344.4035.0	Bottom BAS GUT GF 16HM32 50 A0	revos BASIC size 16H closed-bottom base with 2 cable glands M32, with cover, high design, double locking lever
73.344.4035.1	Bottom BAS GUT GF 16HM32 50 A1	revos BASIC size 16H closed-bottom base with 2 threaded collars M32, with cover, high design, double locking lever
73.345.4035.0	Bottom BAS GUT GG 16HM32 50 A0	revos BASIC size 16H closed-bottom base with cable gland M32, left, with cover, high design, double locking lever
73.345.4035.1	Bottom BAS GUT GG 16HM32 50 A1	revos BASIC size 16H closed-bottom base with threaded collar M 32, left, with cover, high design, double locking lever
73.346.4035.0	Bottom BAS GUT GH 16HM32 50 A0	revos BASIC size 16H closed-bottom base with cable gland M32, right, with cover, high design, double locking lever
73.346.4035.1	Bottom BAS GUT GH 16HM32 50 A1	revos BASIC size 16H closed-bottom base with threaded collar M32, right, with cover, high design, double locking lever
73.347.4035.0	Bottom BAS GUT GI 16HM32 50 A0	revos BASIC size 16H closed-bottom base with cable gland M32, bottom, with cover, high design, double locking lever

73.347.4035.1	Bottom BAS GUT GI 40HM32 50 A1	revos BASIC size 16H closed-bottom base with threaded collar M32, bottom, with cover, high design, double locking lever
---------------	--------------------------------	---

These dimensions will be especially checked at delivery
Only inspection dimensions
With /E marked dimensions are only valid for internal use

Diese Maße werden bei Abnahme besonders geprüft
Ausschließliche Prüfmaße
Mit /E gekennzeichnete Maße sind nur für interne Zwecke gültig

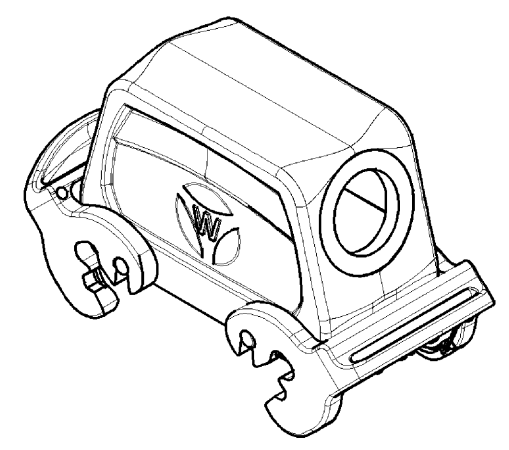
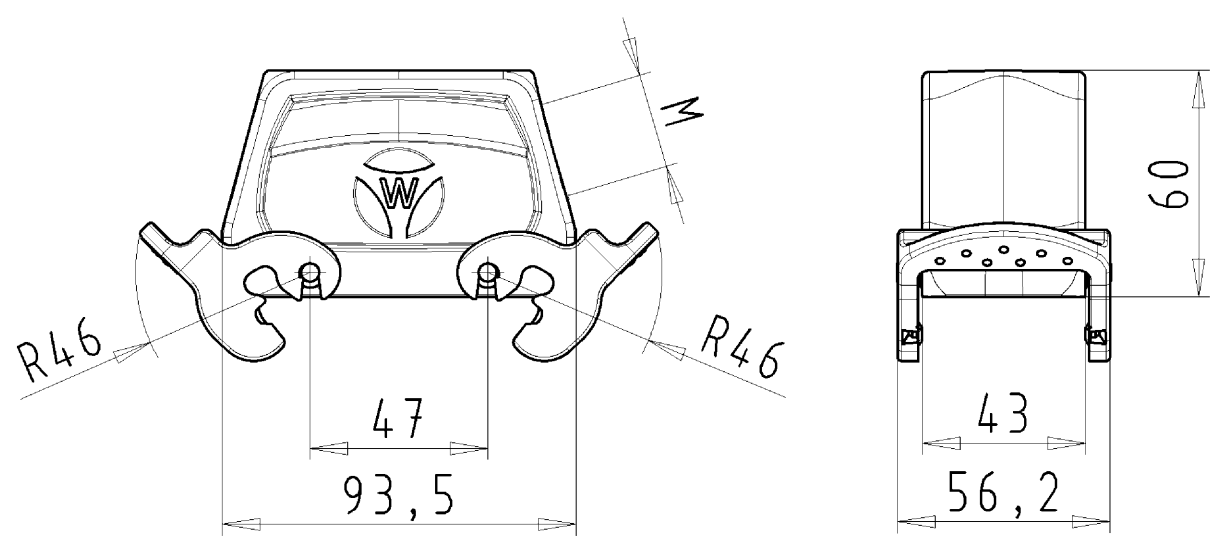

Varianten/ Variants

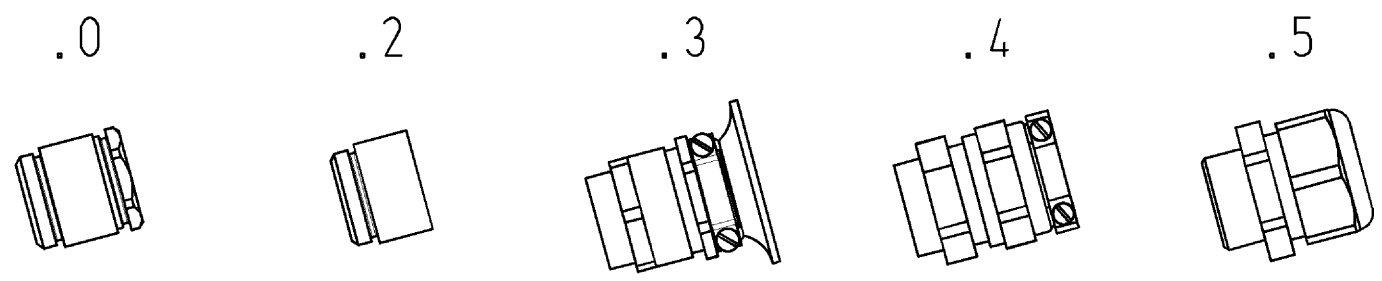

70.35 ⁸ ₅ .1635.5	BAS GOT GD 16	M32 M25	A 5	Kabelverschraubung{KV}, IP65 /Cable gland{CG}, IP65	
70.35 ⁸ ₅ .1635.4	BAS GOT GD 16	M32 M25	A 4	KV mit Zugentlastung, IP54 /CG with strain relief, IP54	
70.35 ⁸ ₅ .1635.3	BAS GOT GD 16	M32 M25	A 3	KV mit Zugentlastung und Knickschutz, IP54 /CG with strain relief and bend support, IP54	
70.35 ⁸ ₅ .1635.2	BAS GOT GD 16	M32 M25	A 2	Zwischenstutzen /Bushing	
70.35 ⁸ ₅ .1635.1	BAS GOT GD 16	M32 M25	A 1	Gewindebohrung /Thread hole	X
70.35 ⁸ ₅ .1635.0	BAS GOT GD 16	M32 M25	A 0	Kabelverschraubung{KV}, IP54 /Cable gland{CG}, IP54	
Bestellnummer /Order number	Typ /Type	Varianten /Variants			dar- gestellt /drawn
Weitere Daten siehe KATALOG oder eKatalog. Additional data see CATALOG or eCatalog.				www.wieland-electric.com eshop.wieland-electric.com	

Tolerierung Size ISO 14405(®)/Tolerance system Size ISO 14405(®). (This ISO-standard describes the envelope principle. According to the envelope principle the deviations of form and parallelism are limited by the size tolerances).				ja/yes <input checked="" type="checkbox"/> Stoffverbots- und Deklarationsliste nach UU-TQM-05/03 ist einzuhalten. Conformity with Wieland document UU-TQM-05/03 (list of prohibited / delectable hazardous substances) to be declared!			
Freitoleranz nach General tolerance		CAD - Zeichnung, keine manuellen Änderungen CAD - drawing, no manual modifications allowed		1.Verwendung: - First Use:		Blatt: 1 von 1 Sheet: of	
		Werkstoff/Material Aluminium beschichtet/ coated grau/ grey		2013 Tag/Date gezeichnet drawn geprüft checked Normgepr. Stand. check		Name Treschan	
		Maßstab/Scale 1:2				T 70.355.1635.0 13K	
		Vol. mm³ Ofl./Surf. mm²		Ersatz für/Replacement for: -		Maße in mm/Dimensions are in mm	
		wieland Elektrische Verbindungen		Type revos BASIC		Benennung/Title GEHAEUSEOBERTEIL Baugröße 16-Kabelabgang seitlich-M25/M32 Hood size 16-cable outlet side-M25/M32	
Index Datum / Blatt Date / Sheet		Änderung/Revision					

Weitergabe sowie Vervielfältigung dieses Dokuments, Verwertung und Mitteilung seines Inhalts sind verboten, soweit nicht ausdrücklich gestattet.
The reproduction, distribution and utilization of this document as well as the communication of its contents to others without express authorization is prohibited.

70.355.1635.013K_2 CAD/M3028 Treschan 2013-09-2010912:11 1.000